

Amplificateurs, réducteurs & adaptateurs

Spécifications techniques

Métalliques - filetage ISO

- Matériaux : laiton nickelé / acier inoxydable 316L sur demande
- Filetage ISO selon EN 60423
- IP66, IP68 avec joint composite ou néoprène

Amplificateur M/F

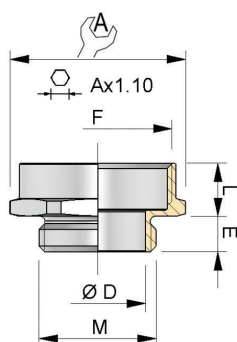

TAILLE

ISO M	ISO F	A	L	E	ØD	COND.	RÉFÉRENCE
M12	M16	18,0	8,0	5,0	8,8	10	CAP755334
M16	M20	22,0	8,0	6,0	12,5	10	CAP750274
M20	M25	27,0	9,0	6,5	16,2	10	CAP750544
M25	M32	36,0	10,5	7,0	21,0	5	CAP750814
M32	M40	42,0	10,5	8,0	28,0	5	CAP751084
M40	M50	52,0	11,5	8,0	35,8	1	CAP751354
M50	M63	67,0	12,5	9,0	45,8	1	CAP751624

Réducteur M/F

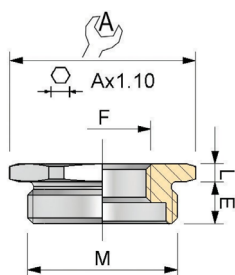

TAILLE

ISO M	ISO F	A	L	E	COND.	RÉFÉRENCE
M16	M12	18,0	2,5	6,0	10	CAP755834
M20	M12	22,0	3,0	6,0	5	CAP750044
M20	M16	22,0	3,0	6,0	10	CAP750024
M25	M16	28,0	3,0	7,0	10	CAP750034
M25	M20	28,0	3,0	7,0	10	CAP750294
M32	M16	36,0	3,5	8,0	5	CAP759104
M32	M20	36,0	3,5	8,0	10	CAP750304
M32	M25	36,0	3,5	8,0	10	CAP750564
M40	M16	44,0	4,0	8,0	5	CAP759164
M40	M20	44,0	4,0	8,0	5	CAP759204
M40	M25	44,0	4,0	8,0	5	CAP750574
M40	M32	44,0	4,0	8,0	5	CAP750834
M50	M40	54,0	4,5	9,0	5	CAP751204
M63	M50	67,0	5,0	10,0	1	CAP751374

EATON

Powering Business Worldwide

Métalliques - filetage Pg

- Matériaux : laiton nickelé / acier inoxydable 316L sur demande
- Filetage électrique Pg - guide : UTE C 68-312 et DIN 40430
- IP66, IP68 avec joint composite ou néoprène

Amplificateur M/F

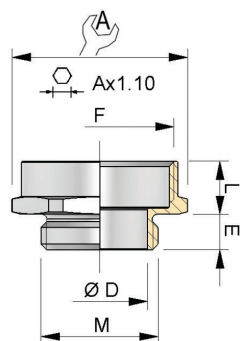

TAILLE

Pg M	Pg F	A	L	E	ØD	COND.	RÉFÉRENCE
Pg7	Pg9	17,0	7,5	4,0	10,0	50	CAP070904
Pg9	Pg11	20,0	8,5	5,0	12,0	50	CAP091104
Pg9	Pg13	22,0	8,5	5,0	12,0	50	CAP091304
Pg11	Pg13	22,0	8,5	6,0	15,0	50	CAP111304
Pg11	Pg16	24,0	8,5	6,0	15,0	50	CAP111604
Pg13	Pg16	24,0	8,5	6,0	16,5	50	CAP131604
Pg13	Pg21	30,0	8,5	6,0	16,5	50	CAP132104
Pg16	Pg21	30,0	10,0	6,0	18,5	50	CAP162104
Pg21	Pg29	40,0	11,5	7,0	24,0	10	CAP212904
Pg29	Pg36	50,0	11,5	8,0	32,0	5	CAP293604
Pg36	Pg42	58,0	15,0	8,0	41,0	1	CAP364204
Pg36	N°48 NFC	64,0	15,0	8,0	41,0	1	CAP364804
Pg42	N°48 NFC	64,0	15,0	8,0	48,0	1	CAP424804
Pg36	Pg48	64,0	15,0	8,0	41,0	1	CAP364884
Pg42	Pg48	64,0	15,0	8,0	48,0	1	CAP424884

Réducteur M/F

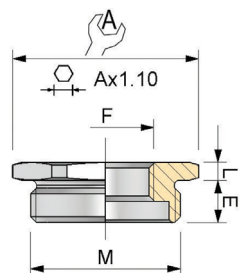

TAILLE

Pg M	Pg F	A	L	E	COND.	RÉFÉRENCE
Pg9	Pg7	16,0	2,0	5,0	100	CAP090704
Pg11	Pg7	20,0	2,0	6,0	100	CAP110704
Pg11	Pg9	20,0	2,0	6,0	100	CAP110904
Pg13	Pg9	22,0	2,5	6,0	100	CAP130904
Pg13	Pg11	22,0	2,5	6,0	100	CAP131104
Pg16	Pg9	24,0	2,5	6,0	100	CAP160904
Pg16	Pg11	24,0	2,5	6,0	100	CAP161104
Pg16	Pg13	24,0	2,5	6,0	100	CAP161304
Pg21	Pg9	30,0	3,0	7,0	100	CAP210904
Pg21	Pg11	30,0	3,0	7,0	100	CAP211104
Pg21	Pg13	30,0	3,0	7,0	100	CAP211304
Pg21	Pg16	30,0	3,0	7,0	100	CAP211604
Pg29	Pg16	38,0	3,0	8,0	50	CAP291604
Pg29	Pg21	38,0	3,0	8,0	50	CAP292104
Pg36	Pg21	38,0	3,5	8,0	10	CAP362104
Pg36	Pg29	48,0	3,5	8,0	10	CAP362904
Pg42	Pg29	58,0	4,0	10,0	1	CAP422904
Pg42	Pg36	58,0	4,0	10,0	1	CAP423604
N°48 NFC	Pg29	62,0	4,0	10,0	1	CAP482904
N°48 NFC	Pg36	62,0	4,0	10,0	1	CAP483604
N°48 NFC	Pg42	62,0	4,0	10,0	1	CAP484204
Pg48	Pg36	62,0	4,0	10,0	5	CAP483684
Pg48	Pg42	62,0	4,0	10,0	1	CAP484284

Métalliques - filetage Pg

- Matériaux : laiton nickelé / acier inoxydable 316L sur demande
- Filetage électrique Pg - guide : UTE C 68-312 et DIN 40430
- IP66, IP68 avec joint composite ou néoprène

Adaptateur Pg Mâle / ISO Femelle

Type 1

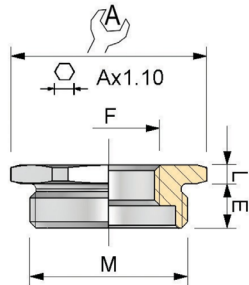

Type 2

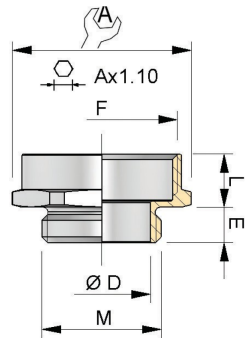

TAILLE

Pg M	ISO F	A	L	E	ØD	Type	COND.	RÉFÉRENCE
Pg7	M12	14,0	7,0	6,5	9,8	1	10	CAP751774
Pg7	M16	19,0	8,5	6,5	9,8	1	10	CAP750094
Pg9	M12	19,0	2,5	6,5	-	2	10	CAP751844
Pg9	M16	19,0	8,5	6,5	12,0	1	10	CAP750104
Pg9	M20	22,0	8,5	6,5	12,0	1	10	CAP750364
Pg11	M12	21,0	3,0	7,0	-	2	10	CAP751874
Pg11	M16	21,0	7,5	7,0	-	2	10	CAP750114
Pg11	M20	22,0	8,5	7,0	15,0	1	10	CAP750374
Pg13	M16	23,0	3,0	7,0	-	2	10	CAP750124
Pg13	M20	24,0	8,5	7,0	16,8	1	10	CAP750384
Pg13	M25	27,0	9,5	7,0	16,8	1	5	CAP750644
Pg16	M16	27,0	3,0	8,0	-	2	10	CAP750134
Pg16	M20	27,0	7,5	8,0	18,5	1	10	CAP750394
Pg16	M25	27,0	9,5	8,0	18,8	1	10	CAP750654
Pg21	M25	32,0	3,5	8,0	-	2	10	CAP750864
Pg21	M32	34,0	10,5	8,0	24,0	1	10	CAP750924
Pg29	M32	42,0	4,0	8,5	-	2	10	CAP750934
Pg29	M40	42,0	10,5	8,5	32,8	1	5	CAP751194
Pg36	M40	51,0	4,5	8,5	-	2	5	CAP751294
Pg36	M50	53,0	11,5	8,5	42,5	1	1	CAP751464
Pg42	M50	58,0	4,5	10,0	-	2	1	CAP751474
Pg42	M63	67,0	13,0	10,0	49,5	1	1	CAP751734
Pg48	M50	54,0	5,0	11,0	-	2	1	CAP751484
Pg48	M63	67,0	13,0	11,0	54,5	1	1	CAP751744

Polyamide - filetage ISO

- Matériau : polyamide 6/6, couleur gris
- Filetage ISO selon EN 60423
- IP66, IP68 avec joint composite ou néoprène

Amplificateur

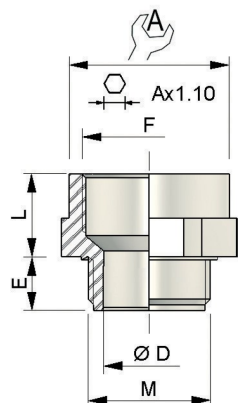

TAILLE

ISO M	ISO F	A	L	E	ØD	COND.	RÉFÉRENCE
M16	M20	24,0	13,0	8,0	11,5	10	CAP750265
M20	M25	29,0	15,0	9,0	15,5	10	CAP750245
M25	M32	36,0	15,0	11,0	20,0	10	CAP750705

Réducteur

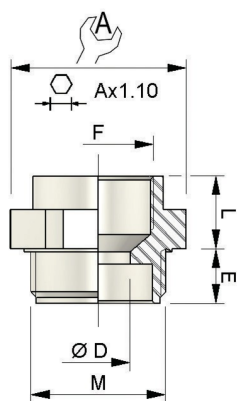

TAILLE

ISO M	ISO F	A	L	E	COND.	RÉFÉRENCE
M20	M12	24,0	4,0	8,0	10	CAP750015
M20	M16	24,0	4,5	8,0	10	CAP750025
M25	M12	29,0	6,0	8,0	10	CAP750275
M25	M16	29,0	6,0	8,0	10	CAP750285
M25	M20	29,0	6,0	8,0	10	CAP750295
M32	M12	36,0	6,0	8,0	10	CAP750535
M32	M16	36,0	6,0	10,0	10	CAP750545
M32	M20	36,0	6,0	10,0	10	CAP750555
M32	M25	36,0	6,0	10,0	10	CAP750565
M40	M16	36,0	6,0	10,0	5	CAP750805
M40	M20	46,0	6,0	10,0	5	CAP750815
M40	M25	46,0	6,0	10,0	5	CAP750825
M40	M32	46,0	6,0	10,0	5	CAP750835
M50	M20	55,0	6,0	10,0	1	CAP751075
M50	M25	55,0	6,0	12,0	1	CAP751085
M50	M32	55,0	6,0	12,0	1	CAP751095
M50	M40	55,0	6,0	12,0	5	CAP751105
M63	M25	68,0	6,0	12,0	1	CAP751345
M63	M32	68,0	6,0	12,0	1	CAP751355
M63	M40	68,0	6,0	12,0	1	CAP751365
M63	M50	68,0	6,0	12,0	1	CAP751375

Polyamide - filetage Pg

- Matériau : polyamide 6/6, couleur gris
- Filetage électrique Pg - guide : UTE C 68-311 et DIN 40430
- IP66, IP68 avec joint composite ou néoprène

Amplificateur

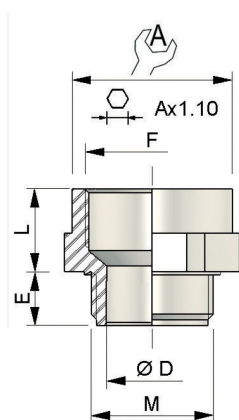

TAILLE

ISO M	Pg F	A	L	E	COND.	RÉFÉRENCE
Pg7	Pg9	19,0	13,5	6,5	10	CAP070970
Pg9	Pg11	22,0	14,0	7,0	10	CAP091170
Pg11	Pg13	24,0	14,0	8,0	10	CAP111370
Pg13	Pg16	27,0	14,0	9,0	10	CAP131670
Pg16	Pg21	32,0	18,5	9,0	10	CAP162170
Pg21	Pg29	41,0	19,5	10,0	1	CAP212970
Pg29	Pg36	55,0	22,0	12,0	1	CAP293670
Pg36	Pg42	60,0	21,0	14,0	1	CAP364270

Réducteur

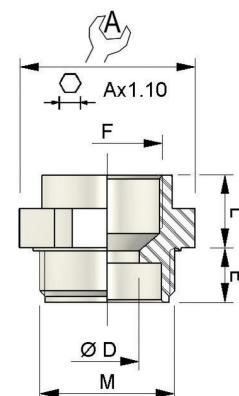

TAILLE

ISO M	Pg F	A	L	E	COND.	RÉFÉRENCE
Pg9	Pg7	19,0	11,0	7,0	10	CAP090770
Pg11	Pg7	22,0	10,5	8,0	10	CAP110770
Pg11	Pg9	22,0	12,0	8,0	10	CAP110970
Pg13	Pg9	24,0	11,5	9,0	10	CAP130970
Pg13	Pg11	24,0	12,0	9,0	10	CAP131170
Pg16	Pg9	27,0	11,5	9,0	10	CAP160970
Pg16	Pg11	27,0	12,0	9,0	10	CAP161170
Pg16	Pg13	27,0	13,0	9,0	10	CAP161370
Pg21	Pg11	32,0	11,5	10,0	10	CAP211170
Pg21	Pg13	32,0	12,5	10,0	10	CAP211370
Pg21	Pg16	32,0	12,5	10,0	10	CAP211670
Pg29	Pg13	41,0	12,5	12,0	1	CAP291370
Pg29	Pg16	41,0	12,5	12,0	1	CAP291670
Pg29	Pg21	41,0	16,5	12,0	5	CAP292170
Pg36	Pg29	55,0	16,5	14,0	5	CAP362970
Pg42	Pg36	60,0	20,5	16,0	1	CAP423670
N°48 NFC	Pg36	60,0	20,5	16,0	1	CAP483670